

# Integrated Elevator Sill Drain (IESD) Installation Instructions

## Contractors pre-installation instructions-

Elevator openings that will receive Integrated Elevator Sill Drains will require being poured or cutback 3" more than the minimum hoist way dimensions required by the elevator manufacturer's drawings.

**Note:** If the elevator is not banked with other elevators and the hoist way is already 3" larger than the manufacturer's requirements (6" for front and rear), no changes should be needed. Please consult with your elevator contractor prior to construction.

Building Drainage must be capable of 100gpm or flow required by code when applicable.

The building owner and or building contractor will be required to ensure that elevator lobby flooring will be level. The width of the elevator door opening, at least three linear feet into the lobby, is required. This is to allow water draining into the IESD to flow without pooling.

Finished flooring must be installed level (within code requirements) with integrated elevator sill drain, grating, and sill. Please coordinate finished floor height with installer.

## ADA

### 303 Changes in level

**303.2 Vertical.** Changes in level of 1/4 inch (6.4mm) high maximum shall be permitted to be vertical.

(Review local code with Authority Having Jurisdiction).

**IESD shall only be installed by Authorized Elevator Personnel.**

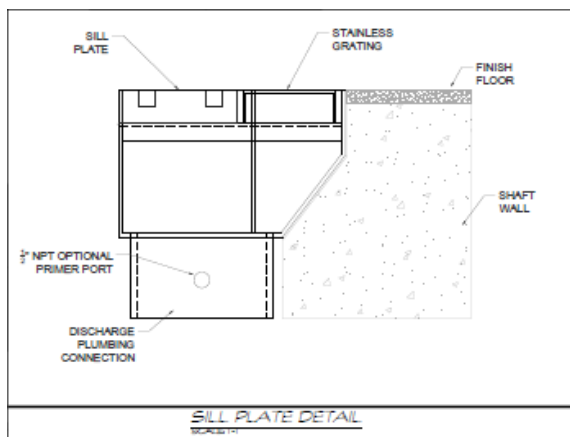

For support please call (615)330-0474 or email [bjackson@highrisesolutionsllc.com](mailto:bjackson@highrisesolutionsllc.com)

High Rise Solutions, LLC. Rev. 7/19

## Integrated Elevator Sill Drain (IESD) Installation Instructions

**Installation Instructions-** Instructions shall be reviewed before installation begins and shall not change the installation process determined by the elevator manufacturer. Contractor requirements must be met for code compliance.

- 1) Begin by removing 1" from the sill's overall length **or** remove ½" from sill groove on each end of sill (refer to drawing). This will provide a ½" gap at the end of the sill for any water that enters the sill groove to drain into the IESD.
- 2) Install elevator sill to the IESD using the hardware provided by sill manufacturer into the sill support slots and tighten. Sill should always be level with grate or slightly higher within code (not to exceed 1/8" higher).
- 3) Install the IESD using a minimum of 8-3/8" bolts to attach to building structure or other brackets attached to building structure. **IESD must be level.**
- 4) Drain outlet shall be connected to plumbing system with 4" flexible socket coupling. Trap primer plumbing connections (if equipped) must be connected with ½" npt threaded fittings. Plumbing connections to be installed by plumbing contractor per local building/plumbing code.
- 5) Stainless steel grating shall be installed with provided hardware. Temporarily cover grate openings during installation and building construction to prevent debris from entering drain. Grating will be aligned, drilled, tapped, and fastened in the field to each sill support leaving an equal space of .25" on the front and back of the grating parallel with the sill (**gaps larger than .25" will void heel proof requirements**). See installation drawings below.

Hardware provided shall include –  
10-24 stainless grate screws, 10-24 tap, #25 drill bit, ¼" (.25") spacers.

**IESD shall only be installed by Authorized Elevator Personnel.**

For support please call (615)330-0474 or email [bjackson@highrisesolutionsllc.com](mailto:bjackson@highrisesolutionsllc.com)

High Rise Solutions, LLC. Rev 7/19.

# Integrated Elevator Sill Drain (IESD) Installation Instructions

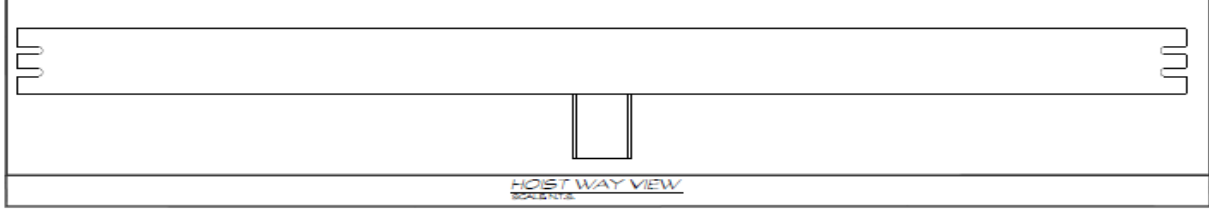
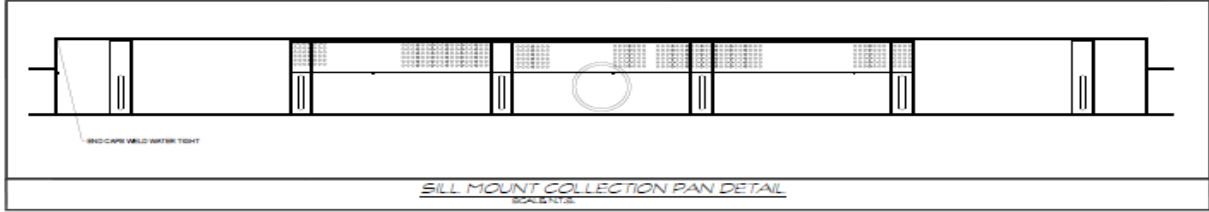
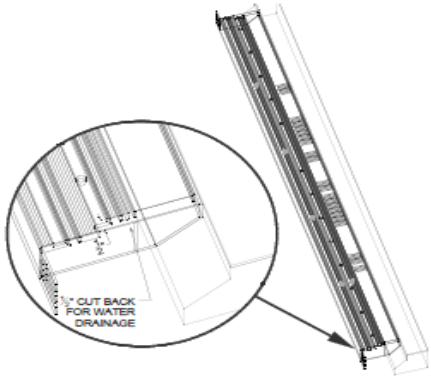
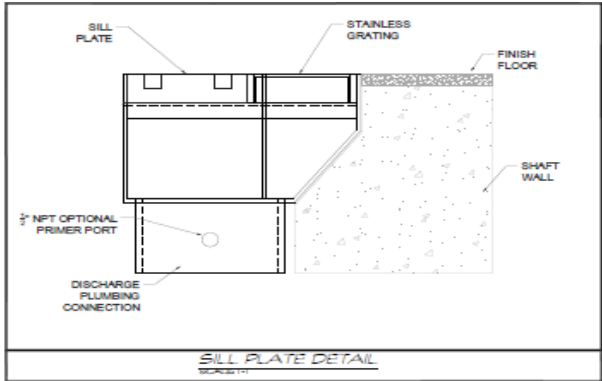

For support please call (615)330-0474 or email [bjackson@highrisesolutionsllc.com](mailto:bjackson@highrisesolutionsllc.com)

# Integrated Elevator Sill Drain (IESD) Installation Instructions